

### CORNER CASTINGS

Easy stacking and lifting points.

### CORTEN STEEL

Known for its unique rust-inhibitive properties, it gives containers durability and resistance to the elements.

### CONTAINER DOORS

Container doors non-functional and welded shut for added security. Interior walls are fully finished for a clean, polished indoor look.

### WEIGHT & DIMENSIONS

Exterior: 20'L x 8'W x 8'6"H  
Interior: 19'4"L x 7'4"W x 7'7"H  
Door opening: 7'8"W x 7'5"H

Forklift pockets: 14"W x 4"H  
Fork spread: 82"W

Weight: 4,900 LBS

### PVC WINDOWS

All Econo boxes are equipped with 1 x full PVC windows for extra visibility to outside on the job site. Dimensions: 46"W x 43"H.

### WEATHERPROOF VENTS

Help reduce heat, humidity and prevent condensation from forming during storage.

### FORKLIFT POCKETS

Facilitate easy loading and unloading.

### INDUSTRIAL MAN DOOR

Industrial grade man door and hardware, designed to endure job site wear and tear.

### PAINT

The 20ft Econo box is painted with low VOC, water-based paint and zinc-enriched primer to ensure maximum resistance to the elements.



### URETHANE INSULATION

The walls, ceiling, and the floor are insulated with 2" of spray foam urethane for optimal comfort.

### AIR CONDITIONING UNIT

An 8,000 BTU air conditioning unit is installed in the front wall.

### HEATING

One baseboard heaters of 2000W each to provide comfort in cold winter months.

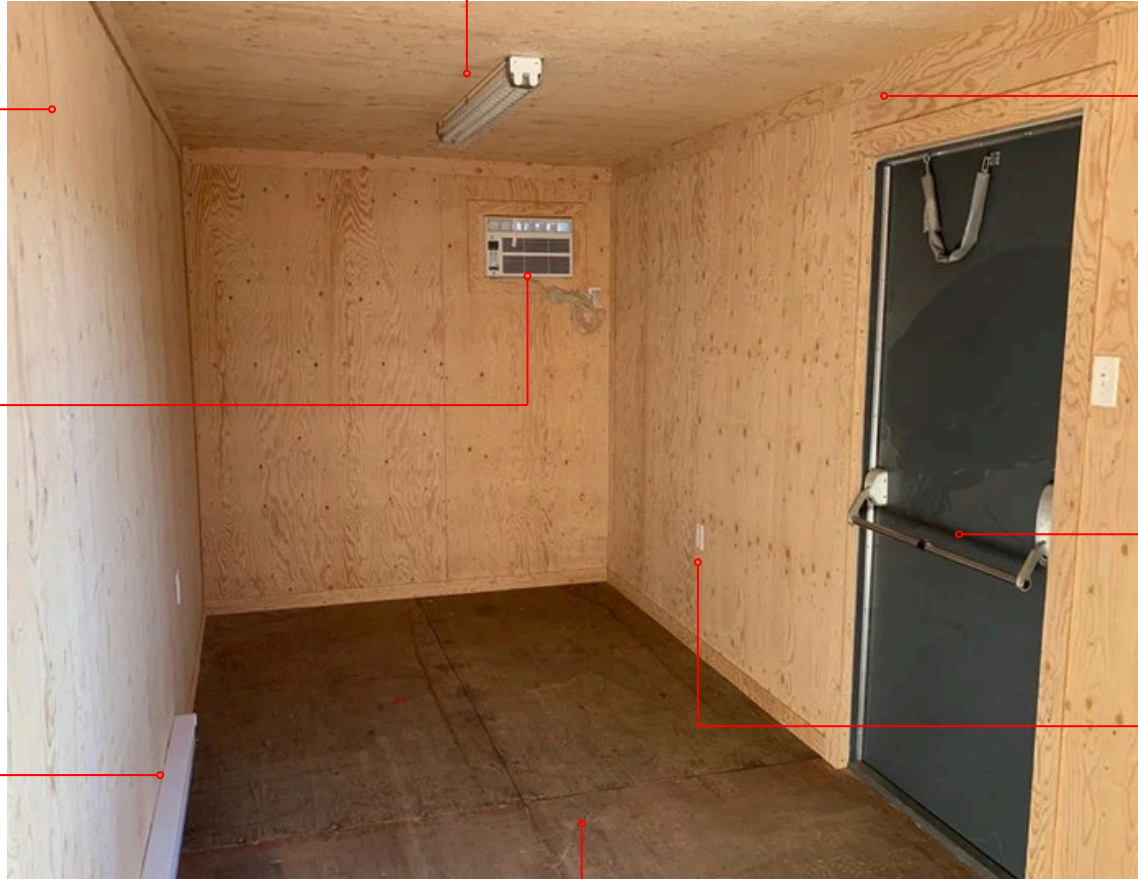

### LIGHT FIXTURES

All job boxes are equipped with 2 x 4' Led light strips

### WALL FINISHING

The walls are finished in 1/2" plywood.

### PUSH BAR

Meets commercial safety standards for exit and emergency applications

### ELECTRICAL OUTLETS

Includes 4 outlets of 120V, 15AMP.

### STANDARD PLYWOOD FLOOR

The Econo Box comes with a standard plywood floor. An upgraded solid vinyl floor finish is also available as an optional add-on at extra cost.

## INCLUDED

### ELECTRICAL PANEL

Electrical kit with 240V service entrance and 100-amp panel, wall-mounted for easy access. Built to meet Canadian electrical standards, it provides a practical and reliable power distribution solution for container offices and modified units.



## OPTIONAL ADD-ON

### AIR CONDITIONER PROTECTIVE CAGE

Heavy-duty metal outdoor air conditioner protective cage designed to help shield the unit from impacts, tampering, and outdoor wear. Built for added safety and durability, it provides strong protection while allowing proper airflow and easy access for maintenance.



## OPTIONAL ADD-ON

### HEAVY-DUTY SECURITY WINDOW SCREEN

Heavy-duty steel security window screen designed to help protect the window from outdoor impacts, accidental damage, and unauthorized tampering. Built for added safety and durability, it provides a strong protective barrier while maintaining airflow and visibility.

